

SEPTEMBER 28 – NOVEMBER 23 2019

uncover

This convergent program considers the implications of concealing and revealing through a related creative residency, a project room – independent studio practice, community make art projects, artist talks + performance events, and a group exhibition featuring contemporary artists: Anna Gustafson, Clea Minaker, Elizabeth Russell, Natalie Nickerson, Heather Passmore and Nadine Bariteau.

The lens based work of Danielle Eglison and Emilie Van Hoderbeke featured in CVAG's Community Gallery, was produced as part of the Magenta Flash Forward Incubator program, facilitated by Dave Ingram at Georges P Vanier Secondary School. The Flash Forward Incubator Program is dedicated to fostering future visual artists in Canada by giving youth from diverse backgrounds the mentorship they need to create their work and a platform to amplify their voices through exhibitions and publications. Danielle and Emilie are in the second year of this emerging artist program centred on relevant thematic concerns.



580 DUNCAN AVENUE COURTENAY BC V9N 2M7
250.338.6211 | COMOXVALLEYARTGALLERY.COM

HOURS TUESDAY TO SATURDAY 10-5
ADMISSION: DONATIONS GRATEFULLY ACCEPTED

The Comox Valley Art Gallery would like to acknowledge that we are located upon the Unceded Traditional Territory of the K'ómoks First Nation. CVAG recognizes the enduring presence of First Nations people on this land.

CVAG gratefully acknowledges the support of Canada Council for the Arts, BC Arts Council, Government of Canada, Province of BC, City of Courtenay, Town of Comox, Comox Valley Regional District, BC Gaming, McLoughlin Gardens Society, SD71 Print Shop, Sherwin-Williams Paint Store, Nakeestla Bed & Breakfast, ABC Printing and Signs, and Hitec Screen Printing. We especially thank our volunteers, donors + members.



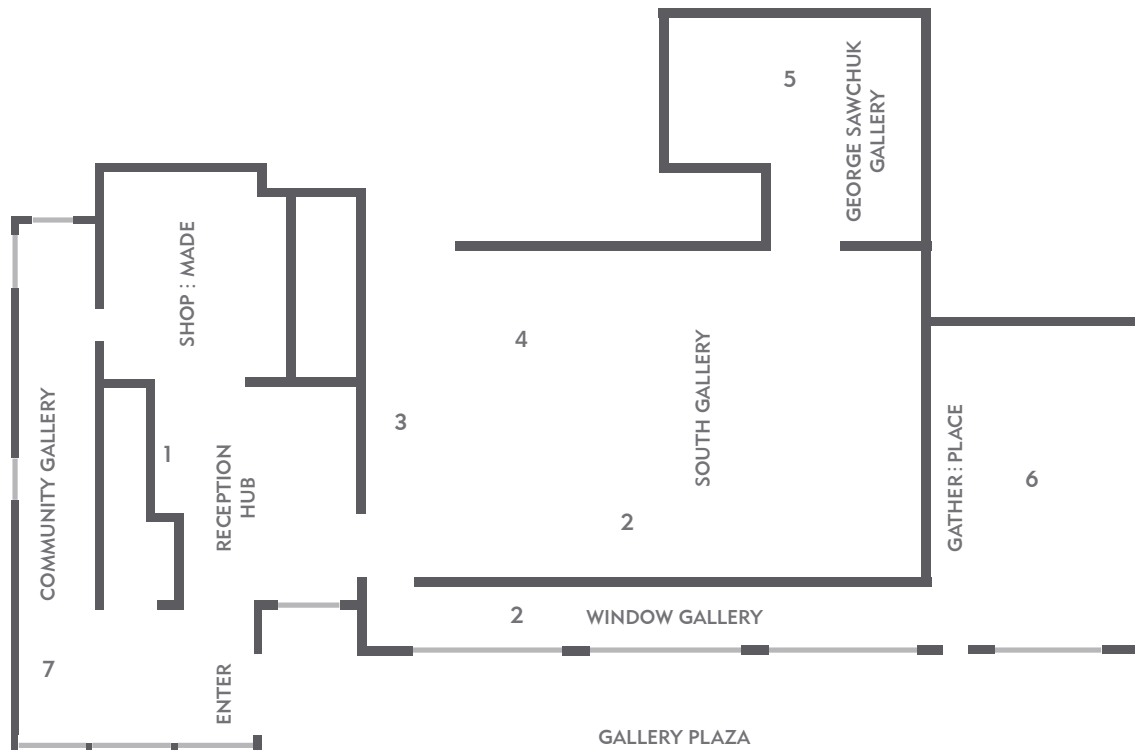

ANNA GUSTAFSON

1. THE HEART OF THE MATTER
One Chapter from *The System is Not Fool Proof* – variable sizes. HD video loop (05:47:23), radiographs of wildlife in rescue facilities – source images courtesy of: New England Aquarium Boston, MA, Vancouver Aquarium Vancouver, BC, Wild Arc Victoria, BC and Anonymous. 2015 – ongoing
2. REMOTE & OBSOLETE
One Chapter from *Object Lessons* – variable sizes. discarded electronics, used linen bed sheets. 2017 – ongoing

NATALIE NICKERSON AND ELIZABETH RUSSELL

3. APOCALYPSE
installation – variable sizes. acrylic on wood panels, printed poem on paper. 2019

NADINE BARITEAU

4. L'ABRIS DE FORTURE
installation – variable sizes. found materials, HD video loop (21:16:13). 2019

CLEA MINAKER

5. PHYSICA
installation – variable sizes. fibre, rocks, lighting, found objects, prisms. 2019
THE MUSIC OF THE FIRMAMENT
performances – September 28, 2019 / 11:15am, 12pm, 3:15pm, 4:14pm. (15:00:00 each)

HEATHER PASSMORE

6. ROMAN CHARITY, triptych – 40" x 55". casein on panel. 2018
BREAST MILK PAINTING 6 panel polyptych – 37" x 56". 2017-2018
LAST NURSE #1 silkscreen on linen – approx. 5' x 5'. 2018
LAST NURSE #2, silkscreen on linen – approx. 5' x 5'. 2018
LAST NURSE #3 silkscreen on linen – approx. 5' x 5'. 2018
EXPIRED BREAST MILK 8 mounted colour photographs depicting the paint making process – 6"x8" to 8"x12". 2018
MILK PORTRAITS silkscreen and casein – 9 panels, variable sizes. 2017

DANIELLE EGILSON / EMILIE VAN HOLDERBEKE -

7. FAULTY CONNECTION (DANIELLE EGILSON) – 2'x3'. colour inkjet prints on vinyl, 2019
NOT BEING SEEN (EMILIE VAN HOLDERBEKE) – 2'x3'. colour inkjet prints on vinyl, 2019